

SENSOR ELECTRODE FOR FLAME DETECTION OR ELECTRIC SPARK IGNITION

PRODUCT: SEL-HT-C□-O□□

☎ Customer Service 55 11 3019-1616

TECHNICAL SHEET 1/6

For further details see technical bulletin

• APPLICATION

⇒ With flame detection sensor electrode: Through conductivity, when gas fuel is used.

With ignitor electrode for flame formation: Through high-tension spark for burner grounded metallic carcass or still between two electrodes

• TECHNICAL DATA

⇒ Metallic electrode: Kanthal A1

⇒ Service Maximum temperature in electrode: 1375°C

⇒ Insulator: technical ceramics (64% de Al_2O_3)

⇒ Service Maximum temperature in insulator: 1200°C

⇒ Ambient Protection Degree: IP 50 using suppressive connection terminal and touch electrical protection. See accessories ACS-CP.

⇒ Metallic electrode can be cut and folded according to application needs.

⇒ Weight: 30 to 100 grams.

⇒ Warranty: 06 months, except for break or crack in ceramic insulator. **(see term of warranty)**

MODELS - Dimensional Draft (mm)

• SEL-HT-C0-O□□ Model

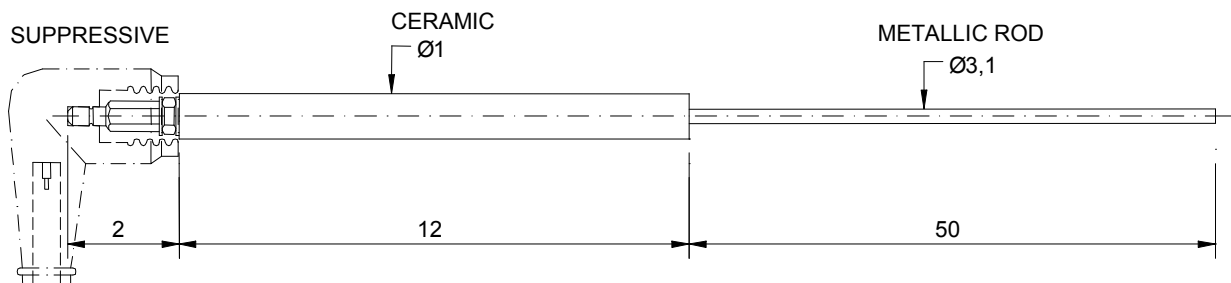

• SEL-HT-C1(2)-O□□ Model

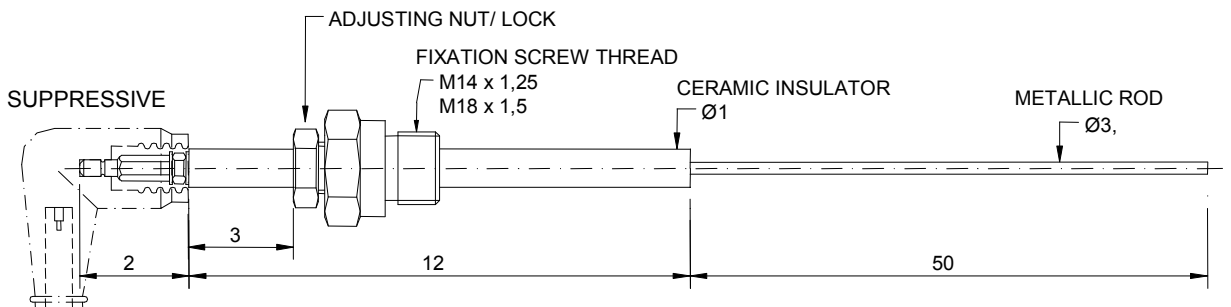

SELCON SISTEMAS ELETRÔNICOS DE CONTROLE LTDA.
CNPJ 56.935.877/0001-29
R. Américo Samarone, 502 • CEP 04284-000 • Moinho Velho •
São Paulo • SP • Brasil • Phone/Fax: (55 11) 3019-1616
<http://www.selcon.com.br>

Representative or Retailer

Selcon Ltda., keeps the right to modify this technical sheet whenever it is necessary – **April/07**

SENSOR ELECTRODE FOR FLAME DETECTION OR ELECTRIC SPARK IGNITION

PRODUCT: SEL-HT-C□-O□□

☎ Customer Service 55 11 3019-1616

TECHNICAL SHEET 2/6

For further details see technical bulletin

• SEL-HT-C3-O□□ Model

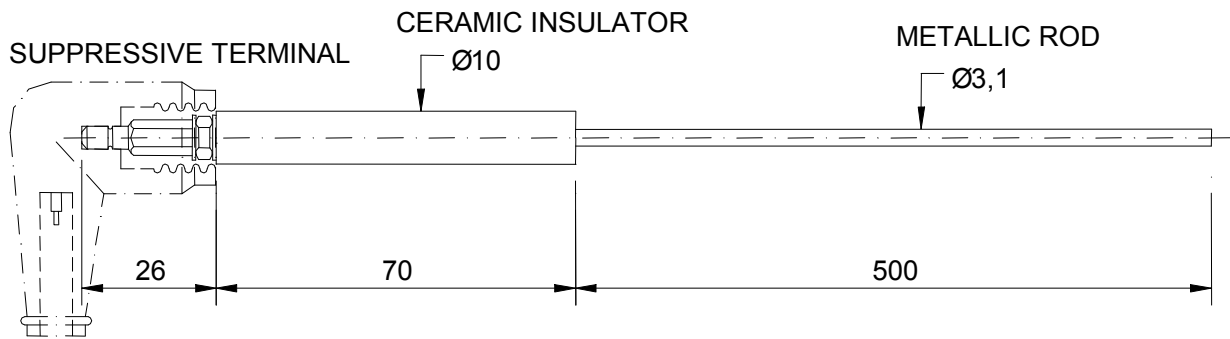

• SEL-HT-C4(5)-O□□ Model

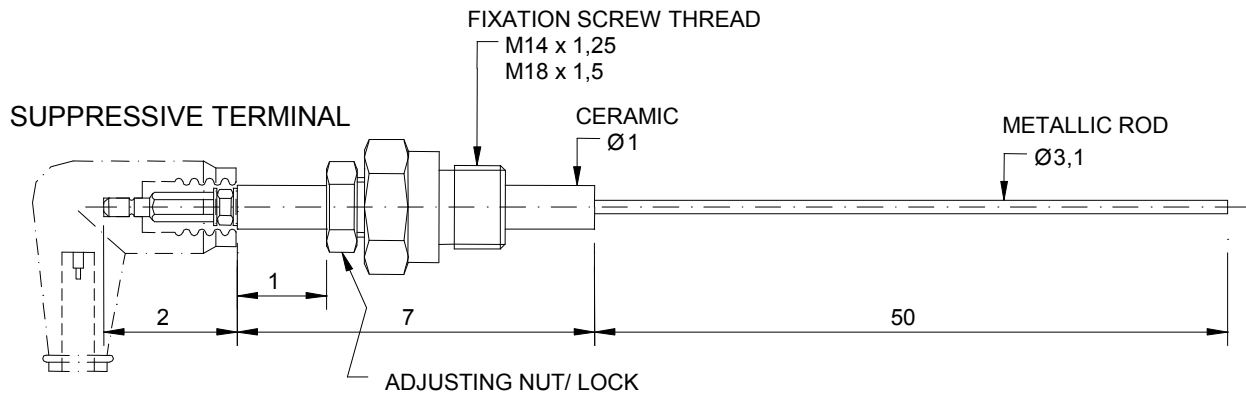

• SEL-HT-C6-O□□ Model

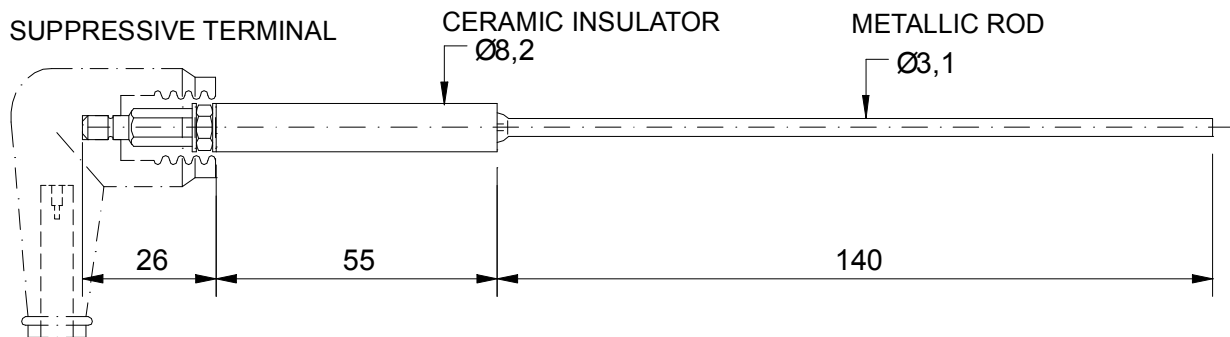

SELCON SISTEMAS ELETRÔNICOS DE CONTROLE LTDA.
 CNPJ 56.935.877/0001-29
 R. Américo Samarone, 502 • CEP 04284-000 • Moinho Velho •
 São Paulo • SP • Brasil • Phone/Fax: (55 11) 3019-1616
<http://www.selcon.com.br>

Representative or Retailer

Selcon Ltda., keeps the right to modify this technical sheet whenever it is necessary – April/07

SENSOR ELECTRODE FOR FLAME DETECTION OR ELECTRIC SPARK IGNITION

PRODUCT: SEL-HT-C□-O□□

☎ Customer Service 55 11 3019-1616

TECHNICAL SHEET 3/6

For further details see technical bulletin

• SEL-HT-C7-O□□ Model

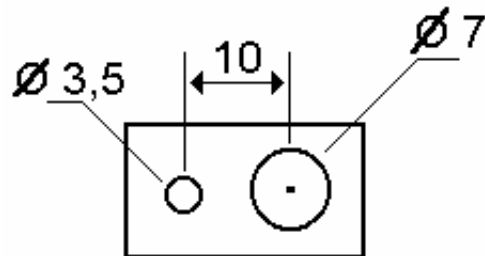
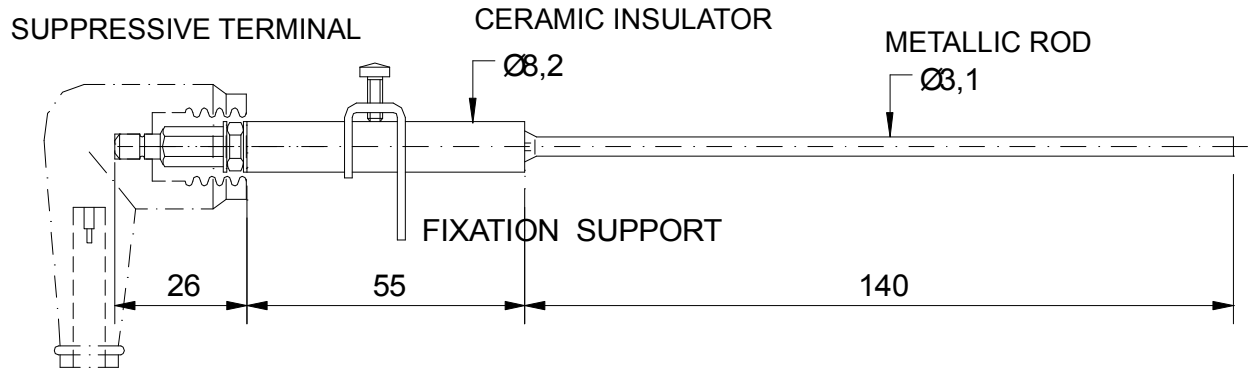

MECHANICAL FIXATION SUPPORT

• SEL-HT-C8-O□3 Model

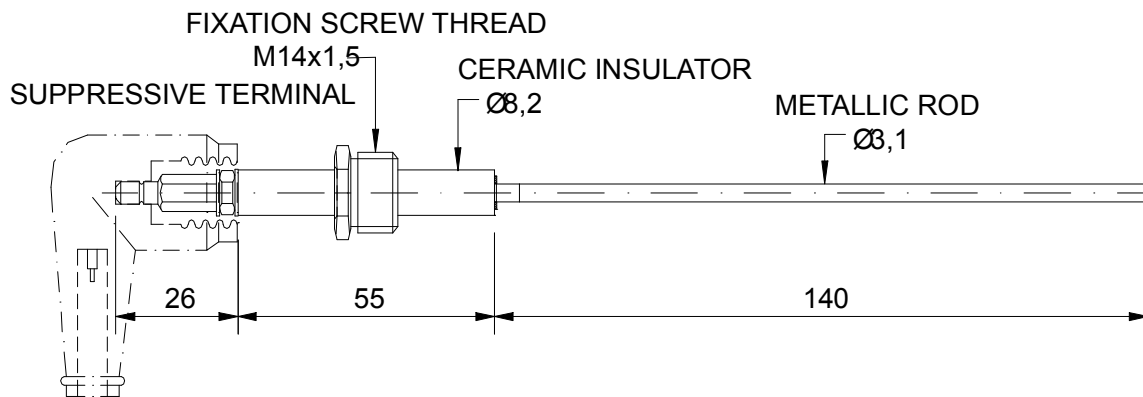

SELCON SISTEMAS ELETRÔNICOS DE CONTROLE LTDA.
CNPJ 56.935.877/0001-29
R. Américo Samarone, 502 • CEP 04284-000 • Moinho Velho •
São Paulo • SP • Brasil • Phone/Fax: (55 11) 3019-1616
<http://www.selcon.com.br>

Representative or Retailer

Selcon Ltda., keeps the right to modify this technical sheet whenever it is necessary – April/07

SENSOR ELECTRODE FOR FLAME DETECTION OR ELECTRIC SPARK IGNITION

PRODUCT: SEL- HT- C□-O□□

☎ Customer Service 55 11 3019-1616

TECHNICAL SHEET 4/6

For further details see technical bulletin

• ORDER CODE - SEL- HT- C□-O□□

SEL- HT	-	C -CONFIGURATIONS	-	O - OPTIONAL	
		□ (d1)		Suppressive Terminal	Ceramic glue
				□ (d2)	□ (d3)

C – Configurations d1:

- 1 - Ø_{ext} of 9,5 mm x 120 mm + 500 mm of rod + fixation plug M14x1,25 mm
- 2 - Ø_{ext} of 9,5 mm x 120 mm + 500 mm of rod + fixation plug M18x1,5 mm
- 3 - Ø_{ext} of 9,5 mm x 70 mm + 500 mm of rod (without fixation plug)
- 4 - Ø_{ext} of 9,5 mm x 70 mm + 500 mm of rod + fixation plug M14x1,25 mm
- 5 - Ø_{ext} of 9,5 mm x 70 mm + 500 mm of rod + fixation plug M18x1,5 mm
- 6 - Ø_{ext} of 8,3 mm x 55 mm + 140 mm of rod (without support or fixation plug)
- 7 - Ø_{ext} of 8,3 mm x 55 mm + 140 mm of rod + fixation support
- 8 - Ø_{ext} of 8,3 mm x 55 mm + 140 mm of rod + fixation plug M14x1,5 mm

O – Optional d2 / d3:

SUPPRESSIVE TERMINAL: d2 = 1 – Without Terminal
 d2 = 2 – Nitric Terminal 100 °C
 d2 = 3 – Silicon terminal 200 °C

Glue application: d3 = 1 – standard, without gluing
 d3 = 2 – electrode gluing/insulator
 d3 = 3 – plug gluing / insulator
 d3 = 4 – electrode and plug gluing / insulator

NOTES: 1- C8 configuration is always supplied with plug gluing / insulator

2- Selcon manufactures under consultation, ignition rods and special ionization sensors (Flame Rod), according to sample, draft or descriptive of the clients needs.

Base Code base SEL-HT-E□□□□/□□, defined by our trade area.



SELCON SISTEMAS ELETRÔNICOS DE CONTROLE LTDA.
 CNPJ 56.935.877/0001-29
 R. Américo Samarone, 502 • CEP 04284-000 • Moinho Velho •
 São Paulo • SP • Brasil • Phone/Fax: (55 11) 3019-1616
<http://www.selcon.com.br>

Representative or Retailer

Selcon Ltda., keeps the right to modify this technical sheet whenever it is necessary – **April/07**

SENSOR ELECTRODE FOR FLAME DETECTION OR ELECTRIC SPARK IGNITION

PRODUCT: SEL-HT-C□-O□□

☎ Customer Service 55 11 3019-1616

TECHNICAL SHEET 5/6

For further details see technical bulletin

• **CAUTION:**

- ⇒ Use programmers and/or detector relays exclusively with flame sensors by Selcon.
- ⇒ It is recommended to install the sensor electrode for flame detection until 8 meters from relay or flame programmer.
- ⇒ Keep sensor surface clean.

• **OTHER PRODUCTS AND ACCESSORIES:**

- ⇒ Flame Relays – CHM-E, CHM-P, CHM-M e CHM-F
- ⇒ Tightness Test Relay of blocking valves – CHM -T
- ⇒ Ignition Programmers and flame monitoring – PRG-E, PRG-Ie, PRG-Ie -IIIme (with base), PRG-I, PRG-M e PRG-M-IIIme (with base)
- ⇒ Optical Flame Sensors– SEL- SV
- ⇒ Flame sensors by ionization and ignitor electrodes – SEL-HT e SEL-HT-E (sensors and electrodes assembled under draft or sample from the special-client).
- ⇒ Flame signal conveyer – ACS –TX (until 500 meters between the sensor and relay or programmer)
- ⇒ Flame Signal Converter for 4 -20 mA – ACS - CV
- ⇒ Ignition transformers – ACS -TE (for feeding in VAC or VCC)
- ⇒ Portable ignitor – ACS-IP (works with common alkaline battery AA type)
- ⇒ Several Cables– ACS - CB (ignition / sensing / communication / control)
- ⇒ Connector and protector to touch for ignition cable – ACS - CP
- ⇒ Temporized ignition panel ACS – IT
- ⇒ Ignition and flame panel – ACS - PI
- ⇒ Articulated socket joint – ACS - CN
- ⇒ Ignition and monitoring panel – ACS-PN (under consultation)
- ⇒ Reform services of pilot burners (under consultation)
- ⇒ **PRODUCTION DATA SUPERVISION LINE**



SELCON SISTEMAS ELETRÔNICOS DE CONTROLE LTDA.
CNPJ 56.935.877/0001-29
R. Américo Samarone, 502 • CEP 04284-000 • Moinho Velho •
São Paulo • SP • Brasil • Phone/Fax: (55 11) 3019-1616
<http://www.selcon.com.br>

Representative or Retailer

Selcon Ltda., keeps the right to modify this technical sheet whenever it is necessary – **April/07**